

PHASE -1

PHASE -2

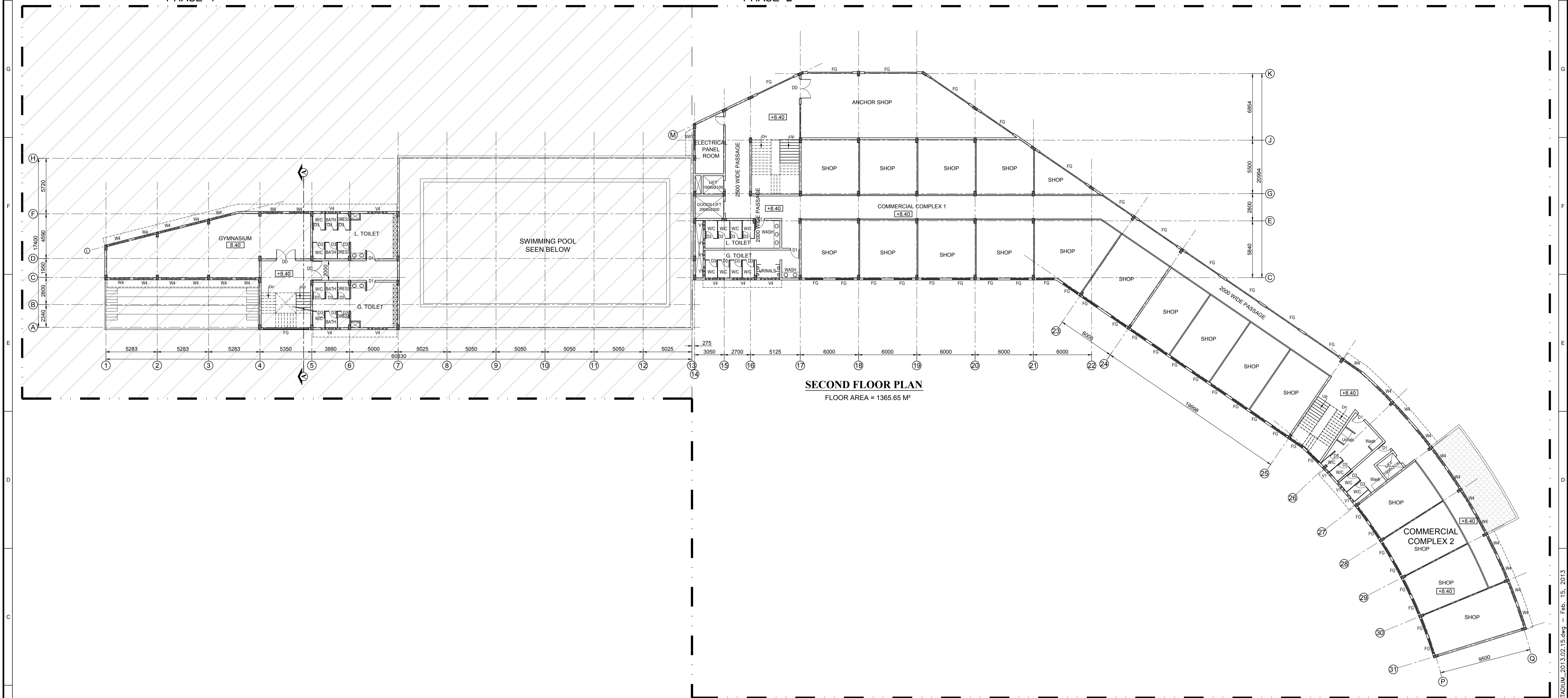

SECOND FLOOR PLAN
FLOOR AREA = 1365.65 M²

NOTE:
1. ALL DIMENSIONS ARE IN MILLIMETERS AND LEVELS ARE IN METERS
2. ONLY WRITTEN DIMENSIONS SHOULD BE FOLLOWED
3. ±0.00 LVL. CORRESPONDS TO FINISHED FLOOR LEVEL.

DETAILS OF JOINERIES		
CD	COLLAPSIBLE SHUTTER	2500 x 2400
CD1	COLLAPSIBLE SHUTTER	2000 x 2400
DD	UPVC DOUBLE DOOR HALF GLAZED	2000 x 2400
DD1	UPVC DOUBLE DOOR FULLY PANELLED	1500 x 2400
D1	UPVC DOOR FULLY PANELLED	900 x 2100
D3	FRP DOOR	800 x 2100
W4	UPVC SLIDING WINDOW	2000 x 1500
V1	UPVC VENTILATOR (Louvered Type)	1000 x 450
V4	UPVC VENTILATOR (Louvered Type)	2000 x 450

DESIGNED		<p>KITCO Ltd. (Estd. in 1972 by IDBI & Govt. of Kerala) PUTHYA ROAD - NH BYPASS, KOCHI - 28</p>												
CHECKED														
DRAWN														
CHECKED														
APPROVED														
SCALE	1 : 200													
UNIT	mm.	CLIENT: NATIONAL GAMES												
DATE	31.01.2013	PROJECT: MUNICIPAL STADIUM AT PALA												
<table border="1"> <thead> <tr> <th>SL.No.</th> <th>PARTICULARS</th> <th>INITIAL</th> <th>DATE</th> </tr> </thead> <tbody> <tr> <td colspan="4" style="text-align: center;">REVISION</td> </tr> <tr> <td> </td> <td> </td> <td> </td> <td> </td> </tr> </tbody> </table>		SL.No.	PARTICULARS	INITIAL	DATE	REVISION								TITLE: - STADIUM CUM COMMERCIAL COMPLEX - SECOND FLOOR PLAN
SL.No.	PARTICULARS	INITIAL	DATE											
REVISION														
<small>This drawing is the property of KITCO Ltd. and is to be used only for the purpose for which it was lent and must not be in any way detrimental to the interest of the company and is subject to return on demand.</small>		DRG NO: DP 586 DRG CL 12 002												
		REV. SHEET NO: 3 OF 5												

I:\2013\586 NG (TM)TRCH\TRP SKD\PALA STADIUM\CIVIL\ESTIMATE PURPOSE\PALA STADIUM_2013.02.15.dwg - Feb. 15, 2013